

# INSTALLATION GUIDE

# **AMP** Power Step RESEARCH MADE IN USA

## APPLICATION

Chevy Tahoe / GMC Yukon / Cadillac Escalade  
Chevy Suburban / GMC Yukon XL / Escalade ESV  
Chevy Avalanche / Escalade EXT

## MODEL YR

2007 - up  
2007 - up  
2007 - up

## PART #

75124-01  
75125-01  
75125-01

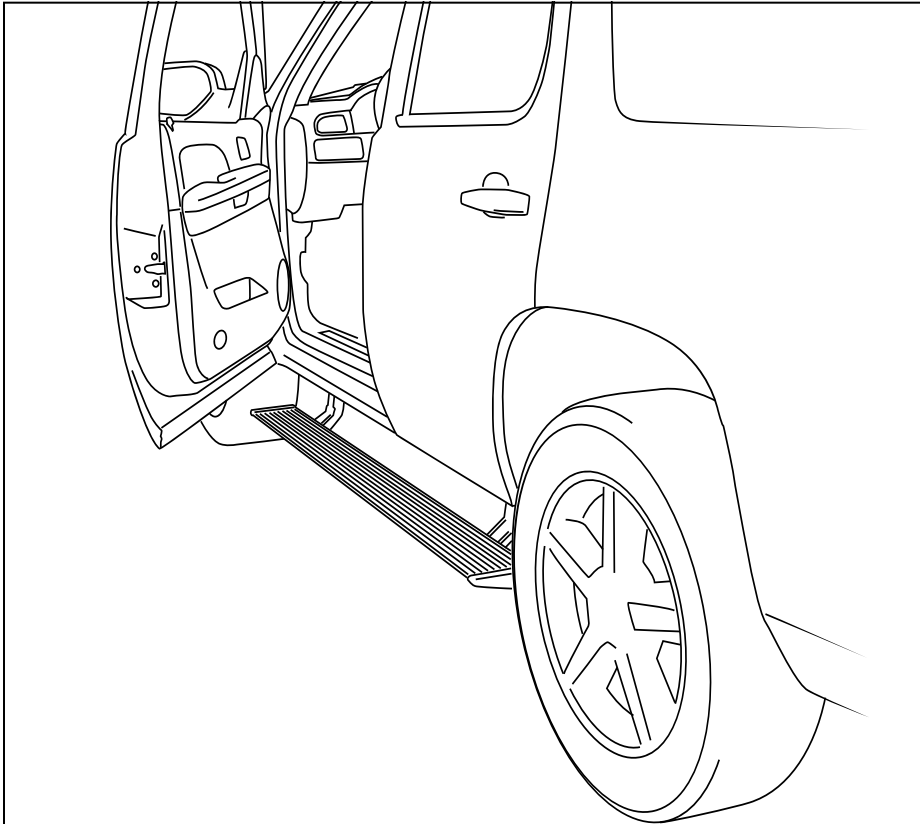

## INSTALLATION TIME



## SKILL LEVEL



## TOOLS REQUIRED

- Safety goggles
- Measuring tape
- Flat blade screwdriver
- Phillips head screwdriver
- Right angle drill
- 9/32" drill bit
- 13 mm socket
- 10 mm socket
- 7 mm socket
- Ratchet wrench and extension
- 13mm end wrench
- Wire stripper / cutter
- Pliers
- Corrosion inhibitor
- 3/16" hex key wrench (allen wrench)
- 5mm hex key wrench (allen wrench)
- Electrical tape
- Weather proof caulking (silicone sealer)

AMP RESEARCH TECH SUPPORT 1-888-983-2204 (Press 2) Monday - Friday, 6:00 AM - 5:00 PM PST

Designed and manufactured by AMP Research®. Patent Number 6,830,257; 6,641,158; 6,834,875; 6,938,909; 6,942,233; 7,007,961; 7,055,839; 7,163,221; 7,367,574; 7,380,807; 7,398,985; 7,413,204; 7,487,986. Other US and Worldwide patents pending. Made in USA © 2010 AMP Research  
5-year limited warranty. Professional installation is recommended.

PARTS LIST AND HARDWARE IDENTIFICATION

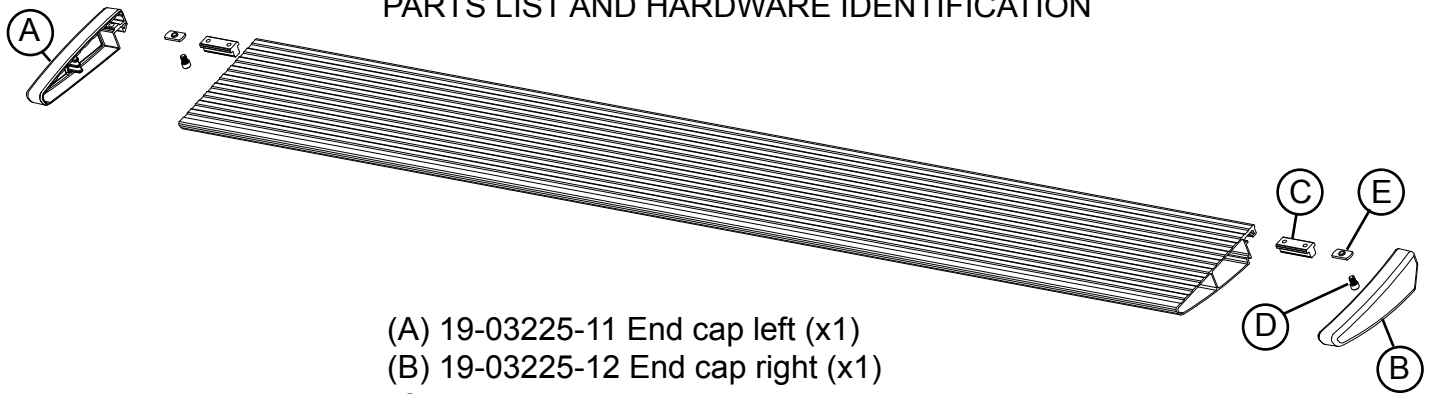

- (A) 19-03225-11 End cap left (x1)
- (B) 19-03225-12 End cap right (x1)
- (C) 19-02663-90 T-nut insert (x2)
- (D) 19-03236-90 Socket cap screw (x2)
- (E) 19-03237-90 Nut plate (x2)

1 x2

Running board assembly

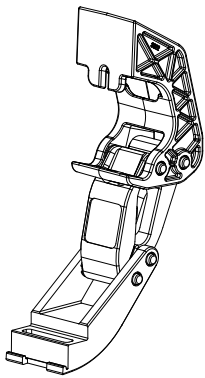

2 x2

10-03273-10  
Idler linkage assembly

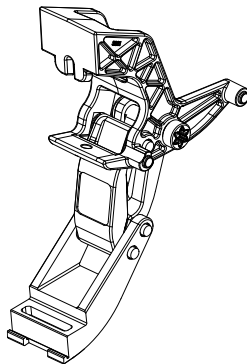

3 x2

10-03272-10  
Motor linkage assembly



4

19-03348-90  
Wire harness

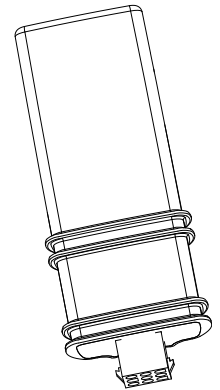

5

19-03297-93  
Controller

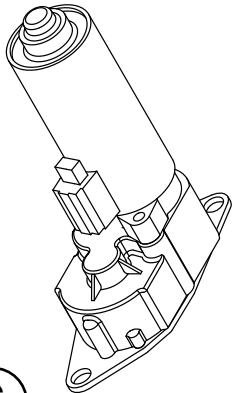

6 x2

19-03289-90  
Motor

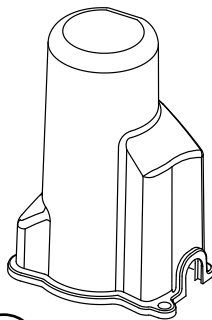

7 x2

19-03238-90  
Motor Cover

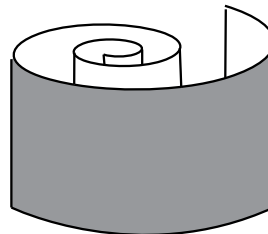

8

19-03403-90  
Rubber Tape

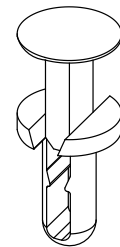

9 x6

19-02721-90  
Cinch Fastener

PARTS LIST AND  
HARDWARE  
IDENTIFICATION

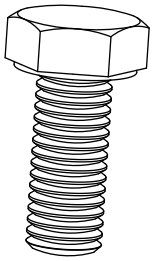

**10** x4  
19-02849-90  
Hex Bolt

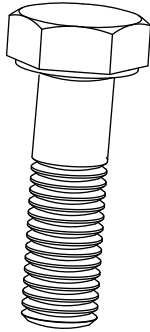

**11** x4  
19-03326-90  
Hex Bolt

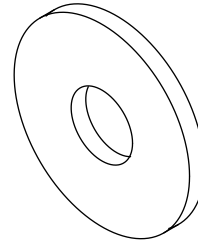

**12** x4  
19-02389-90  
Washer



**13** x4  
10-00115-60  
Nylock Nut

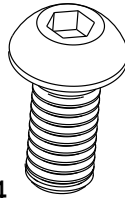

**14** x4  
16-02634-90  
Button Head Bolt

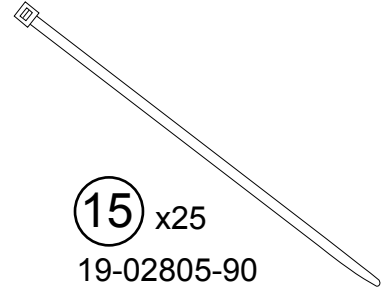

**15** x25  
19-02805-90  
Cable tie (7")

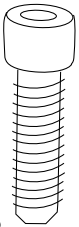

**16** x8  
19-02802-90  
Socket Cap Screw

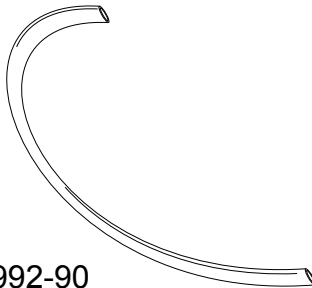

**17**  
19-02992-90  
Tubing (Installation Tool)

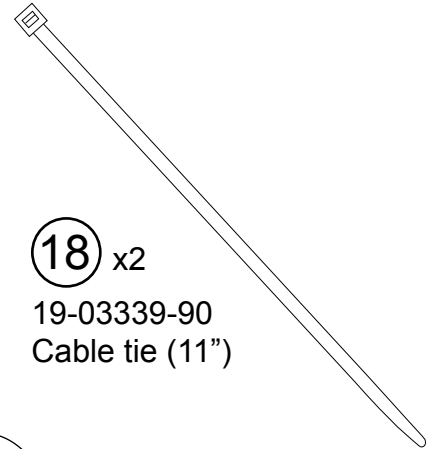

**18** x2  
19-03339-90  
Cable tie (11")

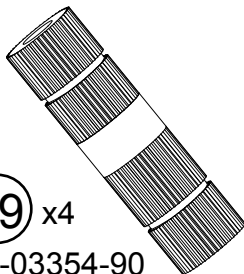

**19** x4  
19-03354-90  
Posi-Tap™

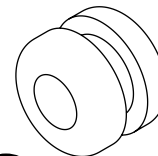





**20**  
19-02640-90  
Grommet

# AMP RESEARCH Power Step

MADE IN USA

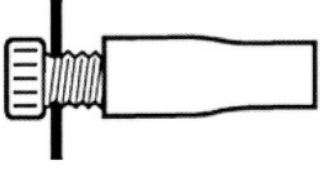
WIRING GUIDE / General Instructions

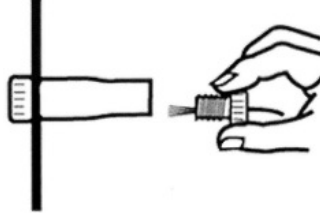
Posi-Tap™ installation instructions

 <p>1. Insert</p>	 <p>2. Tighten</p>	 <p>3. Strip 3/8"</p>
 <p>4. Insert &amp; Tighten</p>	 <p>For two or more wires twist.</p>	<p>Posi-Tap™ Patents: 5,228,875; 5,695,369; 5,868,589, 2,708. Other patents pending</p>

**CAUTION**

- Handle the motor and linkage assemblies with care when installing. Dropping can damage motor.
- Remove fuse from wiring harness during installation. Failure to do so could result in severe electrical shock.

AMP RESEARCH TECH SUPPORT 1-888-983-2204 (Press 2) Monday - Friday, 6:00 AM - 5:00 PM PST

Designed and manufactured by AMP Research. Patent 6,830,257 / 6,641,158 / 6,834,875 / 6,938,909 / 6,942,233 / 7,007,961 Other US and worldwide patents pending. 5-year limited warranty. Professional installation is recommended.

Bolt idler linkage assembly to rearmost mounting tab using an M8 nut and washer (some vehicles may require a M8 x 35 bolt) and a M8x16 Button Head Screw.

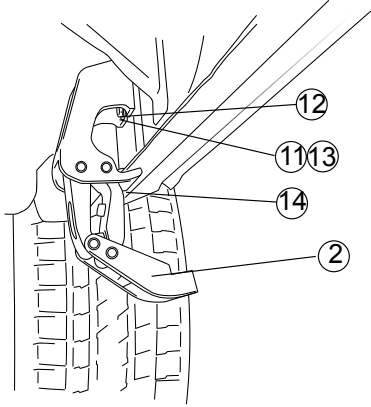

1

Bolt driving linkage assembly to forward most mounting tab using an M8 nut and washer (some vehicles may require a M8 x 35 bolt) and a M8x16 Button Head Screw.

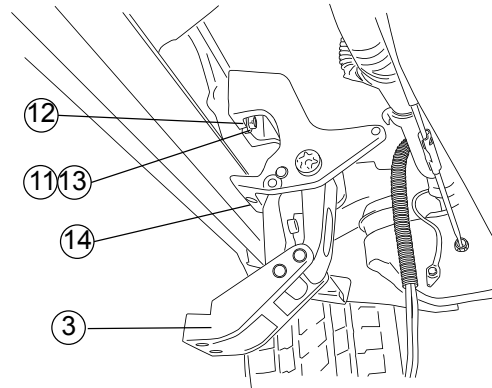

2

Slide mounting T-nut into position. Mount board and tighten fasteners to 10 ft-lbs. Align the end of the board with the rear edge of the back door.

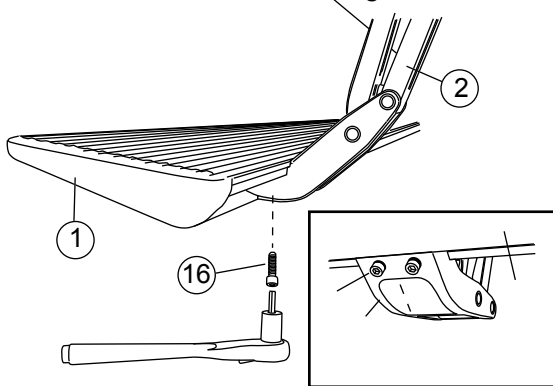

3

Tighten button head fasteners and M8 nuts on driving and idler linkages to 16 ft-lbs.

On some vehicles the emergency cable bracket may come in contact with linkage arm. If so, wrap supplied rubber tape around bracket.

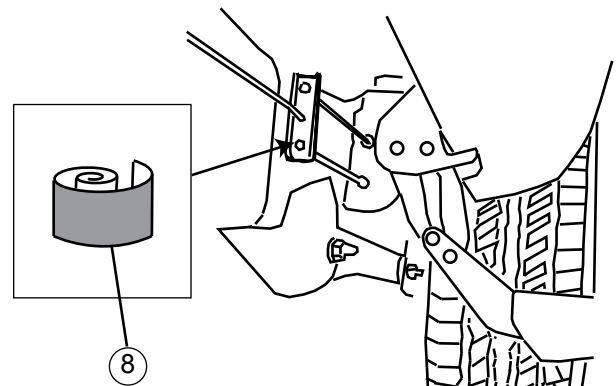

4

Using the two 11" cable ties, mount controller to support arm next to battery

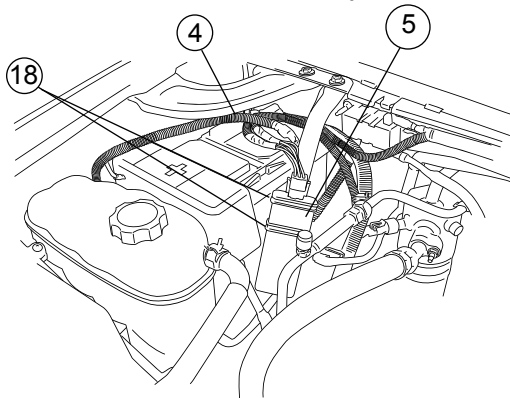

5

Plug in wire harness. (Ensure that locking tabs engage.)

Remove power fuse. Attach power lead (RED wire) to positive pole on the battery.

**CAUTION:** Do not ground wrench when engaged with nut.

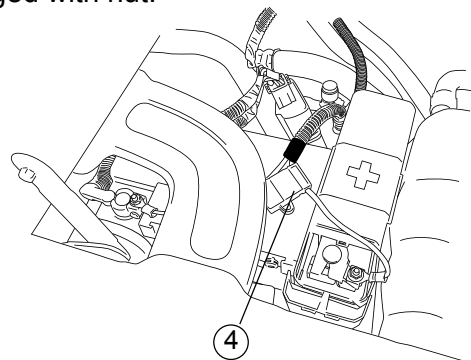

6

Attach ground lead to negative battery pole.

Route long end of wire harness above engine and down through drivers side wheel well. Zip tie harness to cowling clips on fire wall. Route short end down passengers side.

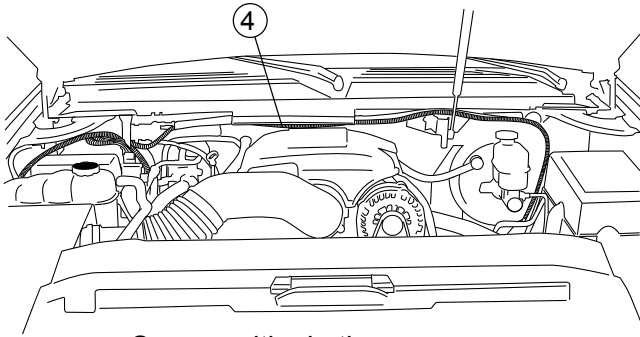

Secure with zip ties.

7

Route wire harness along the frame. Secure with zip ties.

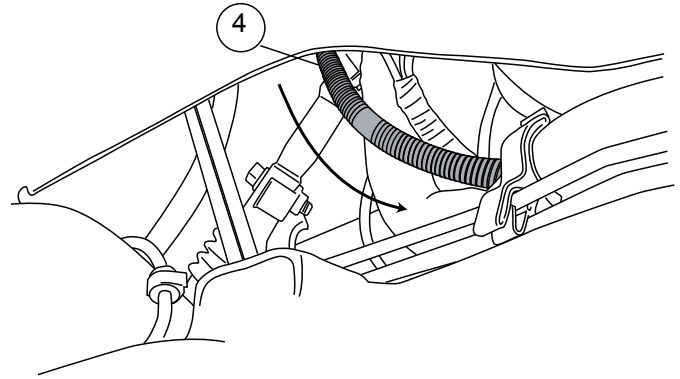

8

Poke hole through rubber grommet near front door on underside of floor panel with small phillips screwdriver. Push both wires through hole.

(See Step 11 for passenger side notes.)

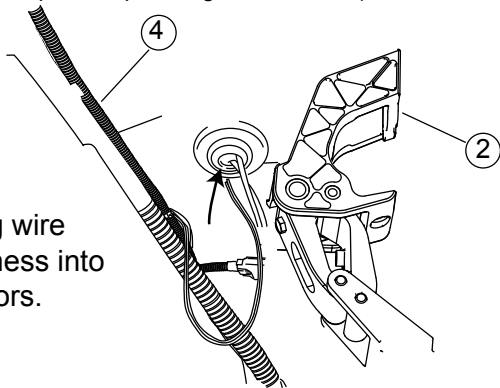

Plug wire harness into motors.

9

Pop off the threshold cover with screwdriver and remove the kick panel. The panel will slide out from under the seat after fasteners give way.

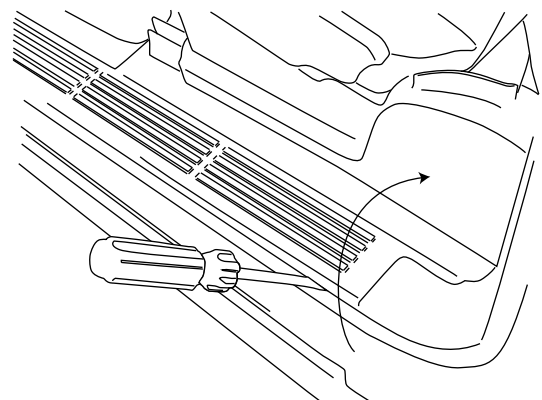

10

Pull up the carpet and thread both wires through the floor panel (same steps on passenger side EXCEPT drill 9/32" hole in metal and add rubber grommet).

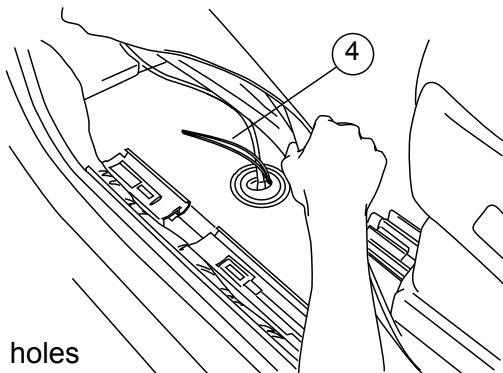

Seal holes with silicon glue.

11

Locate wire loom in door sill. Carefully remove wire wrap and find the trigger wire.

**Drivers side:** LIGHT BLUE wire with BLACK STRIPE

**Passenger side:** GREEN wire with BLACK STRIPE. (Locate wire rearward of junction shown in step 13)

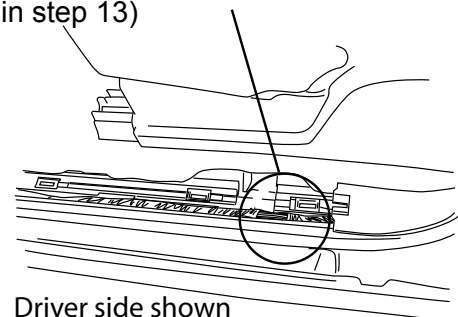

Driver side shown

12

Using Supplied Posi-Tap™ connector, splice shorter trigger wire into wire found in Step 12.

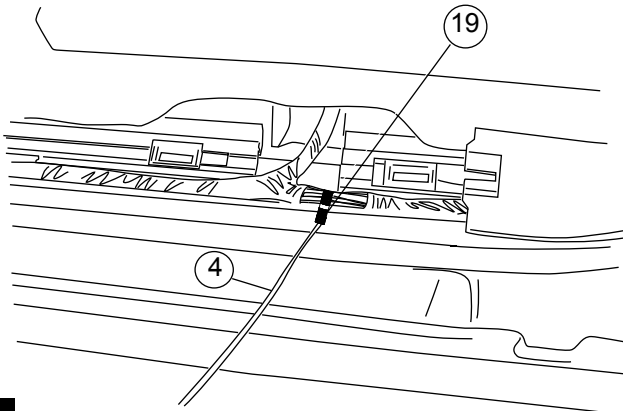

13

Remove plastic trim on door near mirror attachment.

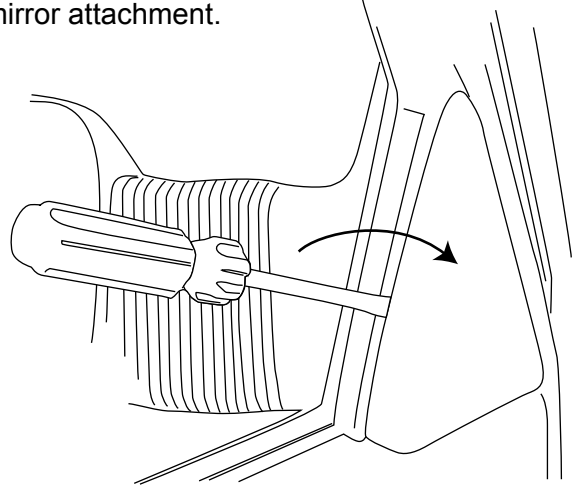

14

Carefully pry up window/ door lock switch plate

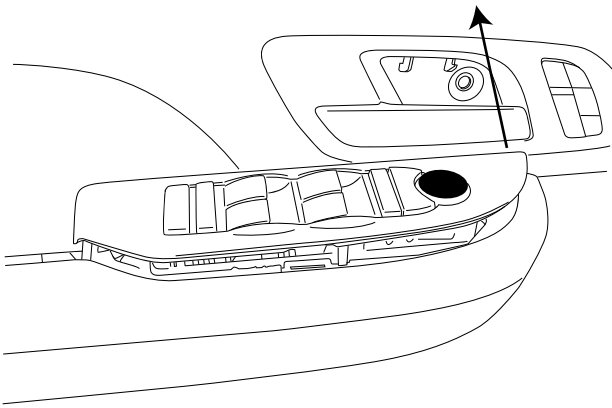

15

Remove all plugs from switchplate

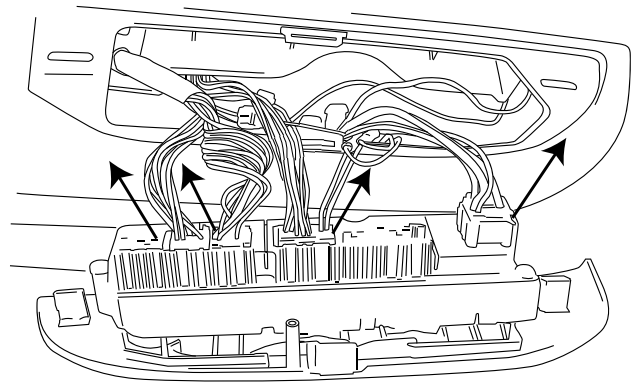

16

To remove door panel, first pry off door lock and plastic covers by handle and door latch. Remove the 3 door bolts and then remove door panel by pring loose all panel fasteners.

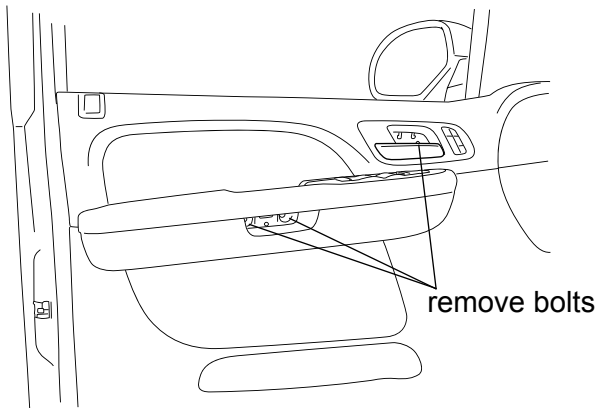

17

Remove door latch cable from door panel

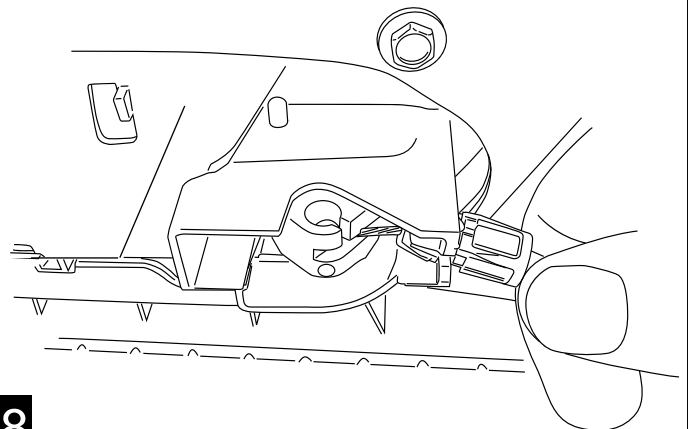

18

Pull back the door weather guard, unbolt speaker and unplug. Thread plastic tube through accordion.

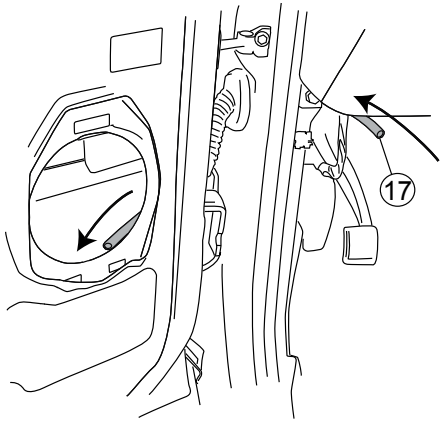

19

Feed longer wire of Step 11 through tube into door and pull out plastic tube on door side. Route wire along harness to switchplate.

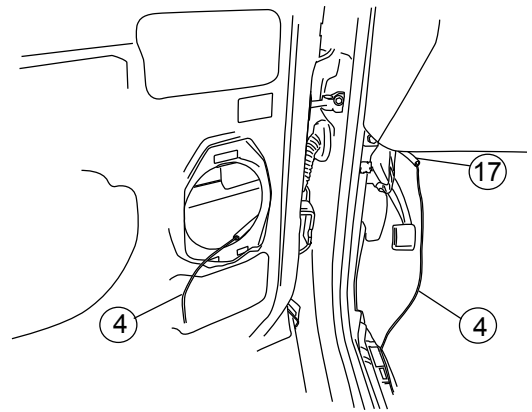

20

Locate the brown plug and using supplied Posi-Tap™ connector, splice into trigger wire.

**2007-2008 Vehicles:**

Drivers side: TAN wire- pin #11

Passengers side: LIGHT GREEN wire-pin#11

**2009 Vehicles:**

Drivers side: Gry/Blk wire- pin #13

Passenger side: Tan/Wht wire- pin # 13

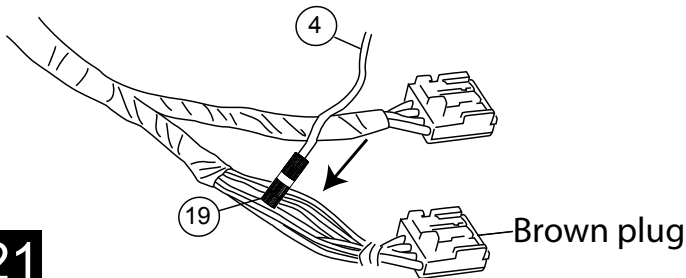

21

Insert plug from wire harness onto motor.

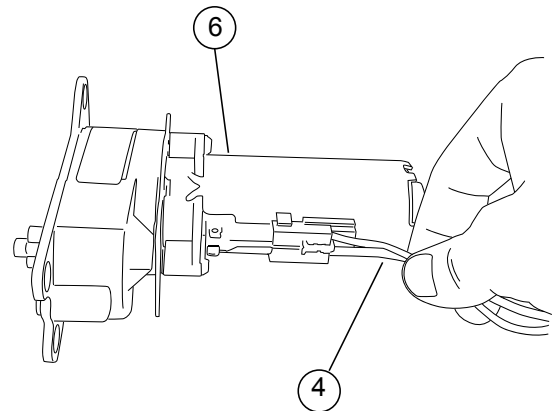

22

Slide rubber grommet on wire harness into slot of motor cover. Insert motor cover onto motor.

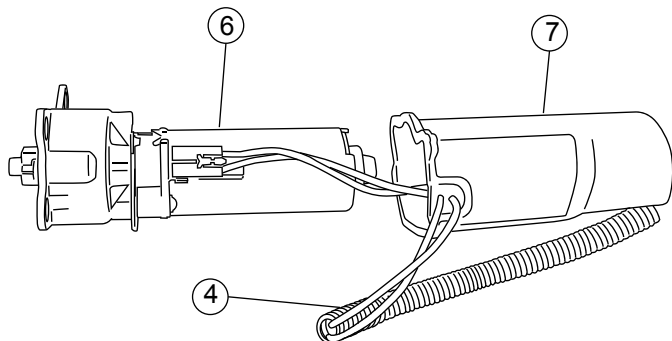

23

Insert plastic push pin rivets in mounting holes of motor cover. Use pliers to ease installation.

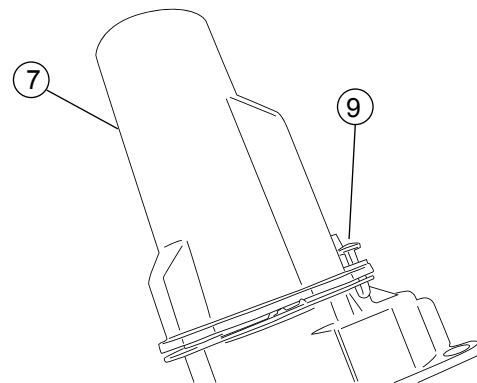

24



Slide motor assembly onto drive shaft and mounting bosses of driving linkage assembly. Use two M8x20 bolts to bolt motor down. Use electrical tape to cover any exposed wire from the motor.

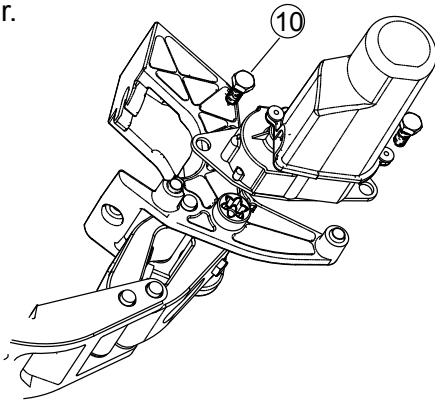

25

Replace power fuse.

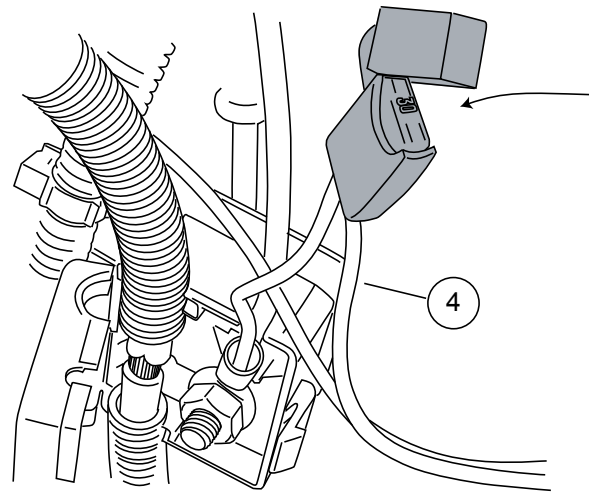

26

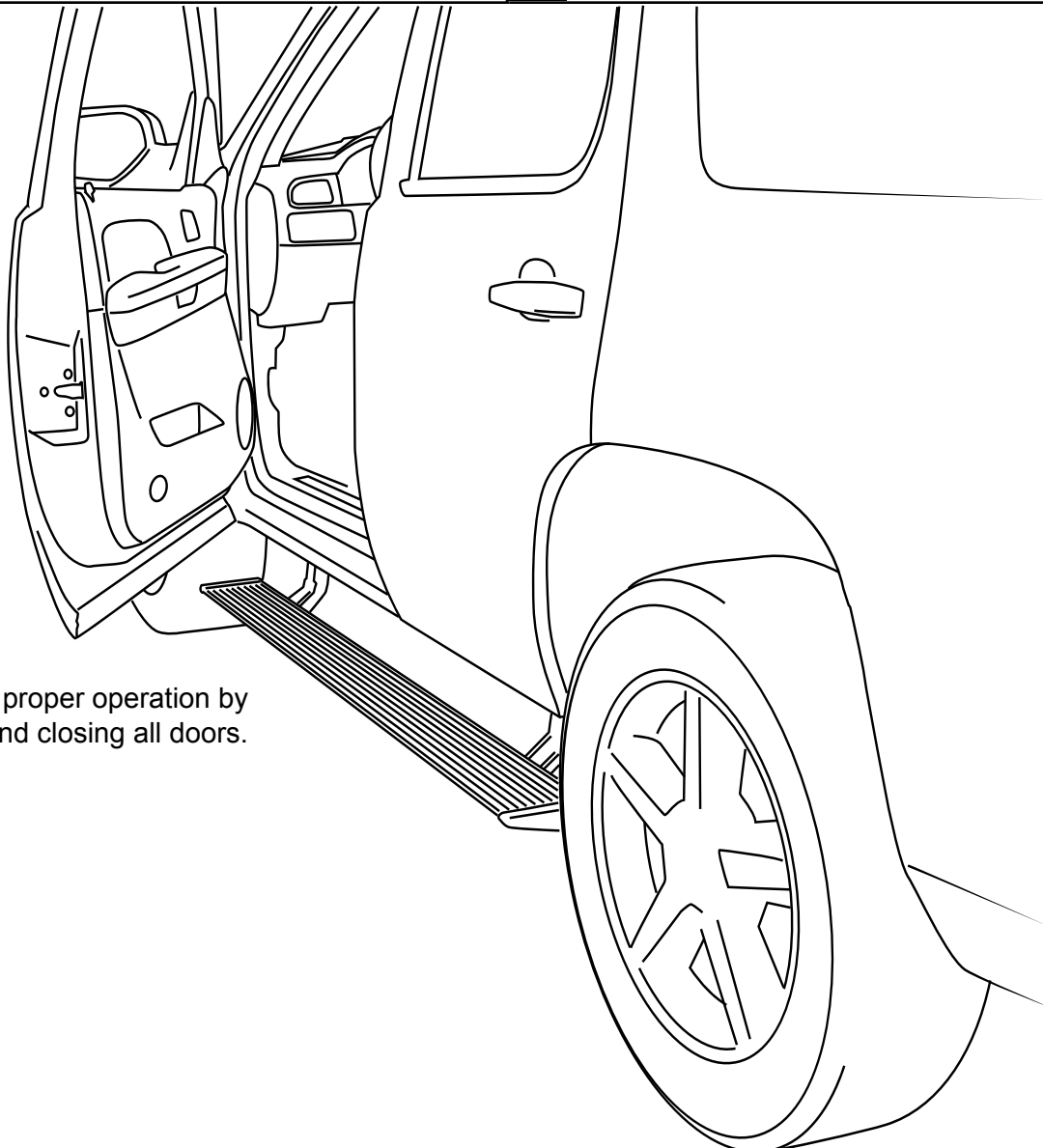

Check for proper operation by opening and closing all doors.

27



# Congratulations on the purchase of your AMP Research Power Step



Here's what you should know...

## OPERATION

The AMP Research Power Step automatically deploys when at least one door opens and automatically retracts under your vehicle when both front and rear doors close. If resistance or blockage is encountered while the Power Step is in motion, the drive system is designed to automatically stop. To reset, simply open or close the vehicle door and the Power Step will resume normal operation.

## MAINTENANCE TIPS

The stepping surface and drive mechanism can be wash with mild soap and water using a soft brush or sponge to dislodge any mud, dirt or accumulated road grime. Rinse with fresh water.

To prevent slipping, avoid applying waxes, lubricants or protectants like Armor All® to the step surface.

When washing your vehicle, the Power Steps can be set to remain deployed with the doors closed for easy cleaning. Do this...

- 1** With the Power Step deployed, press and hold the board down with your foot.
- 2** Close the door while continuing to press down the board. (This will not harm motor.)
- 3** To reset the Power Step, simply open and close the door. (Repeat for both sides of vehicle.)

**CAUTION! BE SURE TO KEEP HANDS AWAY WHEN THE POWER STEP IS IN MOTION.**

[amp-research.com](http://amp-research.com)

## LIMITED WARRANTY

AMP RESEARCH warrants product to be free from defects in material and workmanship, for terms specified below, provided there has been normal use and proper maintenance. All remedies under this warranty are limited to the repair or replacement of any item found by the factory to be defective within the time period specified.

If you have a warranty claim, first you must call our factory at the number below for instructions. You must retain proof of purchase and submit a copy with any items returned for warranty work. Upon completion of warranty work, if any, we will return the repaired or replaced item or items to you freight prepaid. Damage to our products caused by accidents, fire, vandalism, negligence, misinstallation, misuse, Acts of God, or by defective parts not manufactured by us, is not covered under this warranty.

THE WARRANTY TIME PERIOD IS AS FOLLOWS: 5-YEARS FROM DATE OF PURCHASE.

ANY IMPLIED WARRANTIES OF MERCHANTABILITY AND/OR FITNESS FOR A PARTICULAR PURPOSE CREATED HEREBY ARE LIMITED IN DURATION TO THE SAME DURATION AND SCOPE AS THE EXPRESS WRITTEN WARRANTY. OUR COMPANY SHALL NOT BE LIABLE FOR ANY INCIDENTAL OR CONSEQUENTIAL DAMAGE.

Some states do not allow limitations on how long an implied warranty lasts, or the exclusion or limitation of incidental or consequential damages, so the above limitations or exclusions may not apply to you. This warranty gives you specific legal rights, and you may also have other rights that vary from state to state.

## WARNING

Be sure to read and precisely follow the provided instructions when installing this product. Failure to do so could place the vehicle occupants in a potentially dangerous situation. After installing or reinstalling, re-check to insure that the product is