



## **INSTALLATION INSTRUCTIONS**

Congratulations – your new Work-Rite load assists are quality products capable of improving the handling and comfort of your vehicle while under load. As with all products, proper installation is the key to obtaining all of the benefits your kit is capable of delivering. Please take a few minutes to read through the instructions to identify the components and learn where and how they are used. It is a good idea to start by comparing the parts in your kit with the parts list below.

***NOTE: IF ANY PARTS ARE MISSING FROM THE KIT,  
PLEASE CALL 1-800-888-0650.  
PLEASE DO NOT CALL OR RETURN THE KIT TO THE DEALER.***

Be sure to take all applicable safety precautions during the installation of the kit. The instructions listed in this brochure and the illustrations all show the left, or driver's side of the vehicle. To install the right side assembly simply follow the same procedures.

### **STEP 1 – PREPARE THE VEHICLE**

With the vehicle on a solid, level surface chock the front wheels. Remove the negative battery cable. Remove the jounce bumpers located under the frame rail. The jounce bumpers, bolts, and nuts will not be re-used with this kit.

### **STEP 2 – PRE-ASSEMBLE THE KIT**

Insert a 3/8"-16 x 1-1/2" flat head bolt through the hole in the center of the upper bracket. Select one Work-Rite load assist from your kit and fasten it to the upper bracket using a flange lock nut and flat washer inserted through the bottom of the Work-Rite, and secured to the flat head bolt. ***See Figure "A".***

***NOTE: An optional spacer may be installed to engage the Work-Rite sooner when a load is applied. To install, place between the Work-Rite and the upper bracket. There should be 1/4" to 3/8" between the Work-Rite and the axle. See Figure "B".***

### **STEP 3 – INSTALLING THE ASSEMBLY ON THE VEHICLE**

Attach the upper bracket onto the vehicle using 3/8"-16 x 1-1/2" hex bolts, flat washers, and flange lock nuts inserted into the holes from the jounce bumper. ***See Figure "A".***

### **STEP 4 – FINISH UP**

Remove the wheel chocks and reconnect the battery cable. Now you're finished and ready to put your Work-Rite to use!

## **PARTS LIST**

|                           |      |   |                                 |   |
|---------------------------|------|---|---------------------------------|---|
| WORK-RITE LOAD ASSISTS    | 1260 | 2 | 3/8"-16 X 1-1/2" FLAT HEAD BOLT | 2 |
| UPPER BRACKET             | 5632 | 2 | 3/8"-16 FLANGE LOCK NUT         | 6 |
| OPTIONAL SPACERS          | 0013 | 2 | 3/8" FLAT WASHERS               | 6 |
| 3/8"-16 X 1-1/2" HEX BOLT |      | 4 |                                 |   |

**Figure "A"**

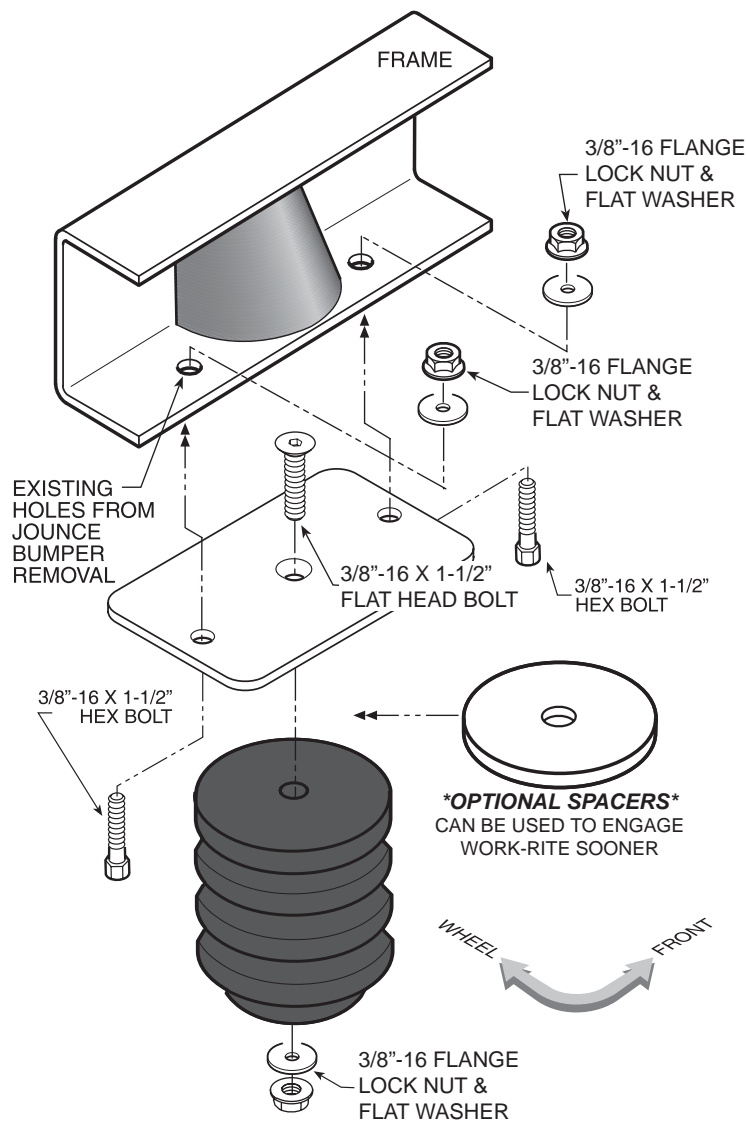

**Figure "B"**

