

INSTALLATION INSTRUCTIONS

Congratulations – your new Work-Rite load assists are quality products capable of improving the handling and comfort of your vehicle while under load. As with all products, proper installation is the key to obtaining all of the benefits your kit is capable of delivering. Please take a few minutes to read through the instructions to identify the components and learn where and how they are used. It is a good idea to start by comparing the parts in your kit with the parts list below.

***NOTE: IF ANY PARTS ARE MISSING FROM THE KIT,
PLEASE CALL 1-800-888-0650.
PLEASE DO NOT CALL OR RETURN THE KIT TO THE DEALER.***

Be sure to take all applicable safety precautions during the installation of the kit. The instructions listed in this brochure and the illustrations all show the left, or driver's side of the vehicle. To install the right side assembly simply follow the same procedures.

PARTS LIST

WORK-RITE	1258	2	5/16"-18 FLANGE NUT	4
UPPER LEFT BRACKET	5624	1	3/8"-16 x 7" CARRIAGE BOLT	4
UPPER RIGHT BRACKET	5625	1	3/8"-16 x 1" HEX HEAD BOLT	4
LOWER BRACKETS	5626	2	3/8"-16 x 2" HEX HEAD BOLT	2
BRACKET CLAMP	5433	2	5/16" J-BOLT	2
BAIL CLAMP	3373	2	3/8"-16" NUT STICK	2
OPTIONAL SPACERS	0013	2	4" WIRE LOOM	2
3/8"-16 FLANGE NUT		8		

NOTE: Both illustrations are of the left, or drivers side, of the vehicle. Reverse any orientations when assembling and installing the right, or passenger, side of the vehicle.

FIGURE "A"

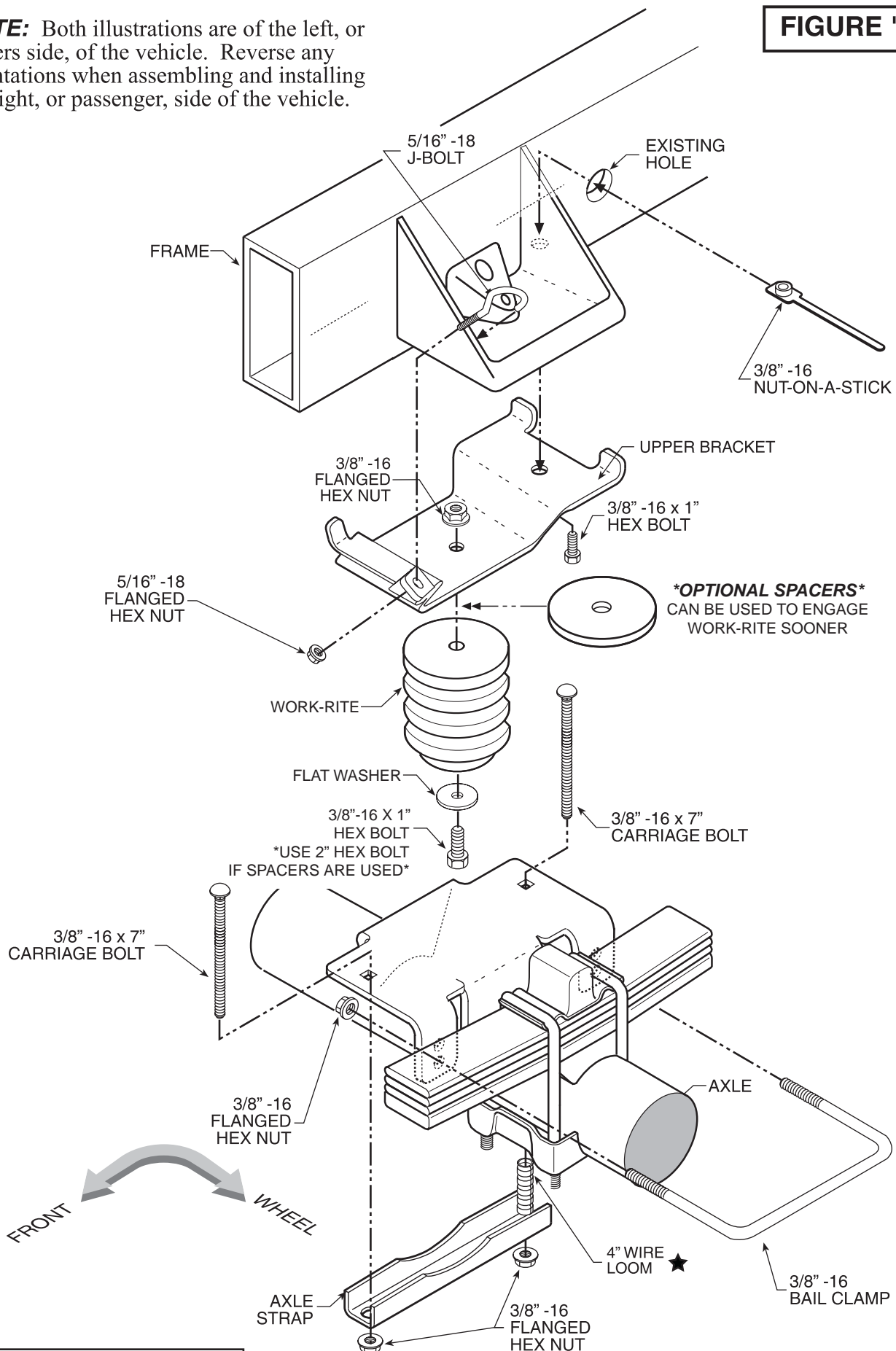

★ PLACE WIRE LOOM ON REAR CARRIAGE BOLT TO PREVENT RUBBING ON EMERGENCY BRAKE CABLE

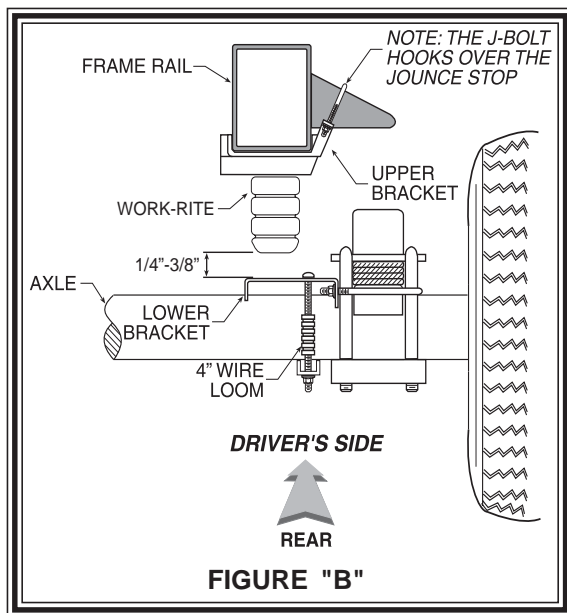

STEP 1 – PREPARE THE VEHICLE

With the vehicle on a solid, level surface chock the front wheels. Remove the negative battery cable. Raise the vehicle by the axle and remove the rear wheels. After the removal of the wheels lower the vehicle so the axle rests on jack stands rated for your vehicles weight. Remove the negative battery cable.

STEP 2 – PRE-ASSEMBLE THE KIT

Select one Work-Rite load assist and one upper bracket from your kit. Install the upper bracket to the Work-Rite load assist by inserting the 3/8"-16 x 1" bolt and flat washer though the bottom of the Work-Rite and into the small hole in the top. Fasten

the Work-Rite to the upper bracket using a flange lock nut. **See Figure "A".**

NOTE: An optional spacer may be installed to engage the Work-Rite sooner when a load is applied. To install, place between the Work-Rite and the upper bracket. If the spacers are installed, use the 3/8"-16 x 2" bolts instead of the 3/8"-16 x 1" bolts. There should be 1/4" to 3/8" between the Work-Rite and the axle. See Figure "B".

STEP 3 – INSTALLING THE ASSEMBLY TO THE VEHICLE

Place the assembly on top of the axle on the left side of the vehicle. Attach the upper bracket to the jounce stop with the 5/16"-18 J-bolt and 5/16"-18 hex nut. Next, insert the nut-on-a-stick through the existing hole in the frame and place it over the hole that is aligned with the hole in the upper bracket. Insert a 3/8"-16 x 1" hex bolt through the bottom of the upper bracket, through the frame rail, and into the nut-on-a-stick. Select one lower bracket from your kit and attach it to the axle using two 3/8"-16 x 7" carriage bolts, the bracket clamp, and 3/8"-16 flange nuts. Place the 4" wire loom over the rear carriage bolt. Be sure that both the upper and lower brackets are not pinching any lines, it may be necessary to reposition some lines to avoid contact with the brackets. Install the bail clamp from the outside of the leaf stack and into the holes on the lower bracket. Secure the bail clamp with two 3/8"16 flanged nuts.

STEP 4 – INSTALLATION OF THE RIGHT SIDE ASSEMBLY

Reverse any orientations when assembling and installing the right, or right side of the vehicle.

STEP 5 – FINISH UP

This now completes the installation. Install the wheels and torque the lug nuts to the manufactures' specification. Raise the vehicle by the axle and remove the jack stands. Lower the vehicle to the ground. Re-attach the negative battery cable and remove the wheel chocks from the front wheels. Now you're finished and ready to put your Work-Rite's to use.