



## Installation Instructions

### Vehicle Application

Year: **2009-13**  
 Make: **Chevy/ GMC**  
 Model: **Silverado/ Sierra 2500HD/ 3500**  
 Engine: **6.0L V8 (w/ Mech. Cooling Fan)**

### Tools Required

- Ratchet and extensions
- 10mm Socket and Wrench
- 3/16" Allen Wrench
- 5/16" Nut Driver or Flat Blade Screwdriver
- Phillips Screwdriver
- 9/16" Wrench
- 3/8" Drill bit and drill

### S&B Filter Maintenance

Cleanable (KF-1055). If the enclosed filter is Red, it came pre-oiled from the factory. Please visit [www.sbfilters.com](http://www.sbfilters.com) for the exact oil amount required after cleaning.

Disposable (KF-1055D). If the enclosed filter is White, it is a disposable filter and should be discarded once it reaches capacity. This filter (does not require oil). For more info on S&B's disposable filter, visit [www.sbfilters.com](http://www.sbfilters.com).

### Notes

Kit may not fit with the following Aftermarket Parts installed:

- Body Lift or Lowering Kit
- Custom Hood
- Throttle body upgrades

### Before You Start

- Please read the entire product guide before proceeding.
- Ensure all components listed on page 4 are present.
- If you are missing any of the components, call our customer support at (909) 947-0015.
- Do not work on your vehicle while engine is hot.
- Make sure the engine is turned off and the vehicle is in Park or the Parking Brake is set.

1. With the ignition switched off and the parking brake set, disconnect the negative battery cable on the passenger's side.



2. Remove the engine cover by lifting it up out of the grommets, then pull towards the front of the vehicle.



3. Disconnect the crank case vent line from the intake tube plenum by gently pulling it out.



4. Disconnect the other end of the crank case vent line from the vehicle by sliding the locking tab over and pull away from the valve cover port.



5. Disconnect the MAF sensor wiring harness from the MAF sensor. **Note:** If equipped, disconnect the Pressure Sensor wiring harness (located on the air cleaner lid) at this time as well.

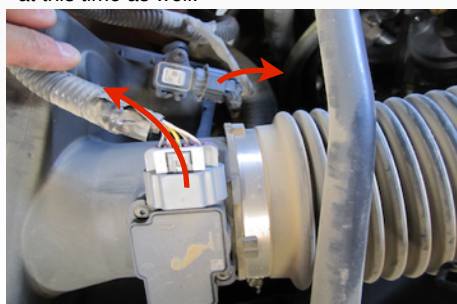

6. Disconnect the intake tube from the throttle body.



7. Disconnect the intake tube from the air cleaner assembly. Then remove the intake from the vehicle.



8. Using a flat blade screwdriver, remove the intake tube from the push pin located on the coolant tube. Then remove the intake from the vehicle.



9. Remove the air cleaner box from the vehicle by carefully pulling it up out of the factory grommets.



**SEE EXPLODED VIEW ON PAGE 4**





**Installation Instructions (continued)**

10. Using 10mm socket, remove the four screws securing the air box mounting tray.

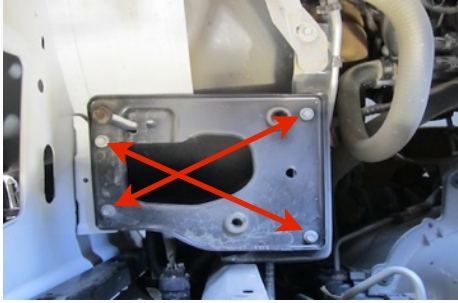

11. For those concerned about minimal engine heat; insert the four Clip Nuts (S) over the holes on the bottom opening of the Air Box (A), insert the Box Plug (T) into the end of the Air Box (A). Attach using the supplied 1/4-20 Hex Screws (U) and Flat Washers (B) from the inside of the Air box using 5/16" socket or ratcheting wrench. For those seeking additional air flow, set the Air Box End Cap aside and save all the supplied hardware. (See page 3 for more info)

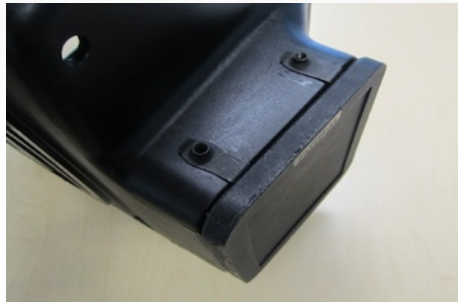

12. Move the coolant reservoir out of the way. Install the Air Box (A) using the two supplied M6x30mm screws (C) and 6mm Washers (B) for the two holes closest to the fender. Use the OE screws for the other two holes. Tighten all four.

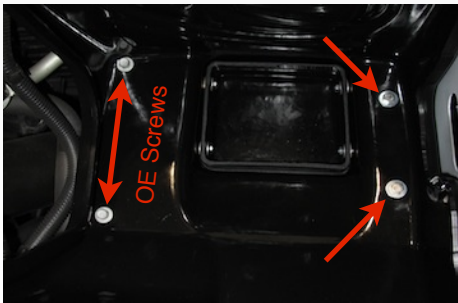

13. Using the supplied T15 Torx Key, remove the MAF sensor from the OE air box. If Equipped, remove the pressure sensor as well.



14. If equipped with Pressure Sensor, Drill a 3/8" hole using the drill point located in the Filter Adapter Tube (Y). Be careful only to drill through one surface (NOT all the way through the backside). Thoroughly clean the inside of the tube of all debris. Then install the pressure sensor using the 1/4-20 Socket Screw (N) and a 3/16" allen wrench.



15. Place the Adapter Tube (Y) into the base of the S&B Air Filter (D) and tighten the #80 Hose clamp (E).



16. Install Filter/ Adapter assembly into the Air box.

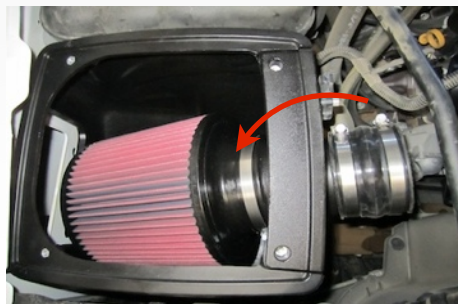

17. Install MAF sensor into the Intake Tube (AA) using the supplied 8-32x1/2" Screws (P). Do not over tighten.



18. Install the 90deg. Hose Barb (V) on to the Intake Tube (AA) until it is hand tight. Then using a 9/16" wrench turn it one more rotation into position as shown.



19. Place a #64 Hose clamp (F) over each end of the Hump Coupler (AB). Then slide the hump coupler over the end of the Adapter Tube (Y). Tighten the clamp closest to the air box.



20. Secure the Silicone Step Coupler (AC) to the throttle body using a #64 Hose Clamp (F). Place the #72 Hose Clamp (G) around the top of the Silicone coupler.

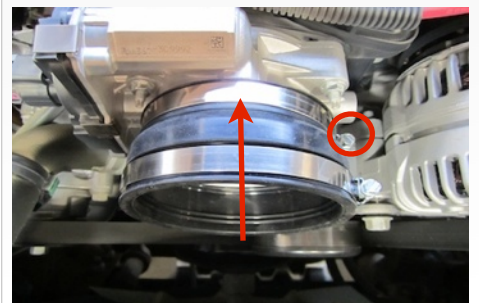

**SEE EXPLODED VIEW ON PAGE 4**





## Installation Instructions (continued)

21. Insert the Intake tube assembly into the Hump Coupler, then push the other end into the Step Coupler at the throttle body. Tighten all hose clamps when you are satisfied with the positioning.

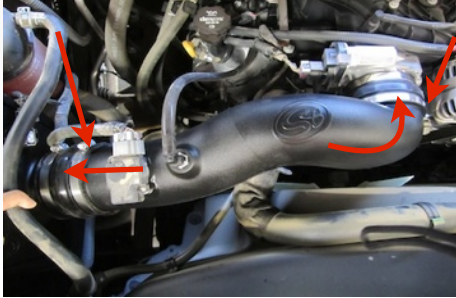

22. Push the Silicone Breather Hose (W) over the Hose Barb (V) on the Intake tube. Then push the other end onto the valve cover vent line. Trim hose to desired fit if necessary. Hose should not be resting on other parts.



23. Reconnect the MAF sensor wiring harness (and Pressure Sensor if equipped).

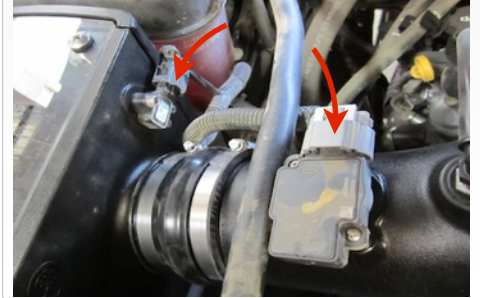

24. Install the Clear Lid (H) using the supplied 5/16" S.S. Screws (K) and Rubber Washers (J) along with the 10-24 Screws (M) and SS Sealing Washers (L). This will secure the Filter Adapter to the Air Box as well. (Do not over tighten!)



25. Re-install the engine cover. Inspect your installation, make sure the kit is properly positioned and all fasteners are secure. Reconnect the battery. The installation is now complete.

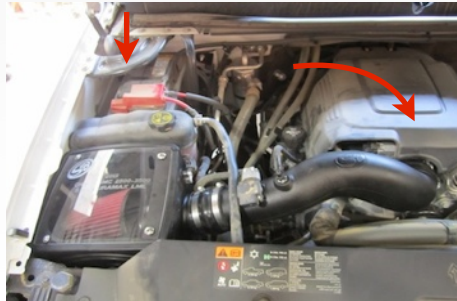

### Testing and Maintenance

- Engage parking brake and start your engine. Listen for abnormal noises. If an air leak is detected, re-inspect hoses and connections as they may need to be repositioned and tightened.
- **S&B FILTERS recommends that you keep your OE intake system in the event it is required in the future.**
- In order to maintain your warranty, all connections and components must be checked periodically for alignment and for proper tension on all connections. Failure to do so may void your warranty.
- Use only S&B FILTERS cleaning and oil products to service your filter. Using any other brand oil and or cleaners on your S&B air filter will void your warranty.

### Precision II Filter Cleaning & Oiling



Order online today at [www.sbfilters.com](http://www.sbfilters.com) or through your local S&B distributor.  
Part #: 88-0008

### Air Filter Wrap Use with Oiled or Dry Filters



Order online today at [www.sbfilters.com](http://www.sbfilters.com) or through your local S&B distributor.  
Part #: WF-1035

### Related Items Available at [www.sbfilters.com](http://www.sbfilters.com)

- Precision II Filter Cleaning & Oiling Kit (S&B P/N: 88-0008)
- Replacement Air Filter (Oiled) (S&B P/N: KF-1055)
- Replacement Air Filter (Dry) (S&B P/N: KF-1055D)
- Air Filter Wrap (S&B P/N: WF-1035)
- Air Scoop (GMC Models) (S&B P/N: AS-1000)
- Air Scoop (Chevy Models) (S&B P/N: AS-1001)

### Air Box End Cap Testing

Stock air boxes are a significant contributor to poor air flow which is why S&B designs custom air boxes with secondary and/or enlarged openings. With that said, S&B recognizes the benefits of cooler air, so we have included a plug to seal off the opening if so desired. For optimal performance, we recommend that the intake be used without the end cap except in conditions of extreme heat.

### Emissions Standard

The California Air Resource Board (CARB) requires that an E.O. identification label be applied to the vehicle in order to pass a smog check inspection when a Performance Intake Kit has been installed. You must place the E.O. label provided on or near the intake kit after installation so that a smog check technician can easily verify the E.O. number. As of April 2009, S&B has never had a product where CARB denied an exemption request; however, the exemption process with CARB can take as long as 18 months. Check the status of the exemption process by looking up a specific part number at [www.sbfilters.com](http://www.sbfilters.com). The CARB Exemption number and/or status is listed under the Product Details section for each part number. If the status shows as "Pending," CARB has yet to issue an exemption. Products that have not been issued an EO number are street legal in most states, but may not be used on emission controlled vehicles in the state of California and are for off road use only. If you purchased your kit from S&B Filters directly, we will automatically mail you your Exemption Sticker when it is issued to us. If you purchased your kit from an authorized S&B Filters Dealer, log onto our web site and register to receive your Exemption Sticker.

SEE EXPLODED VIEW ON PAGE 4



**Exploded View**

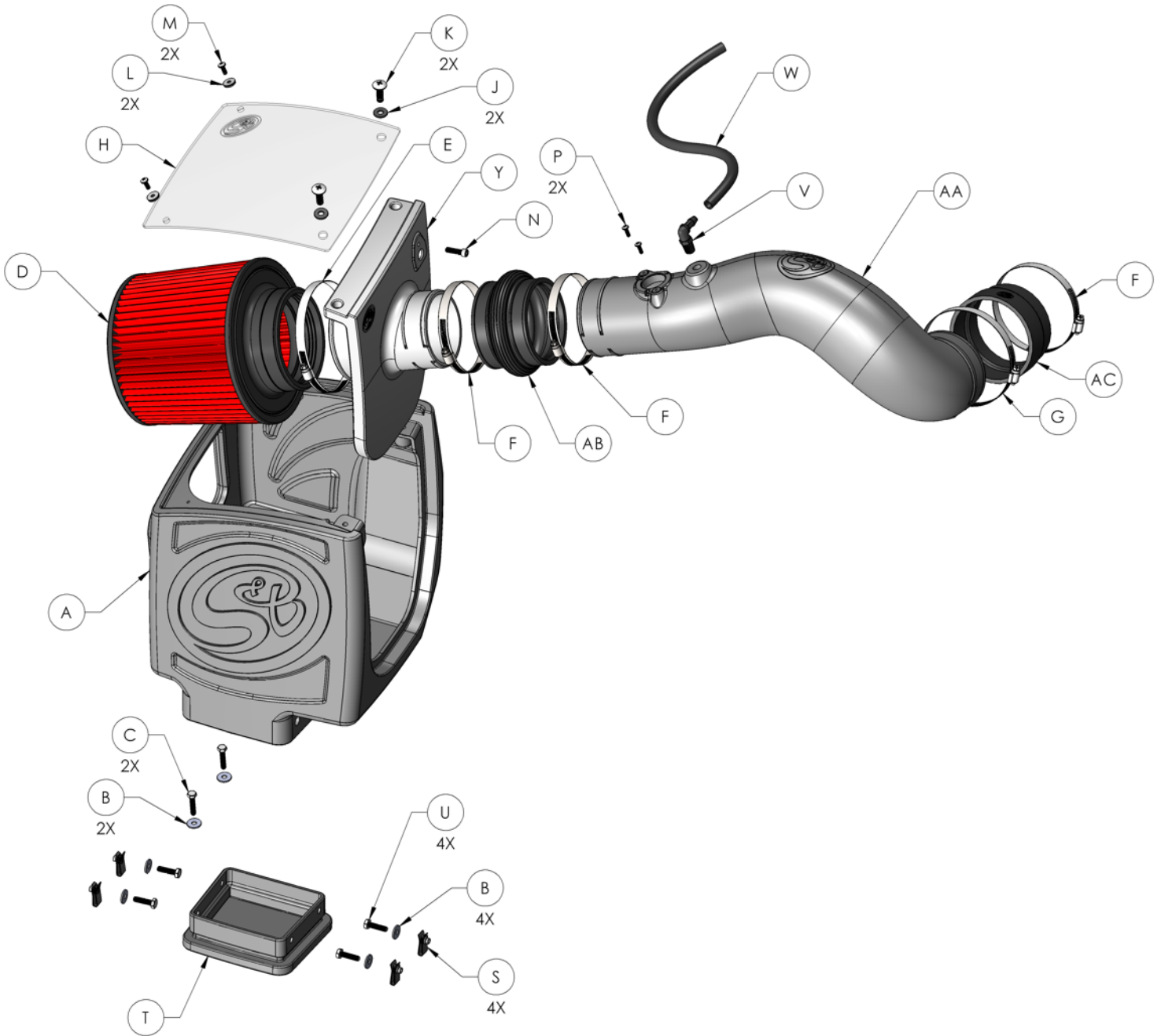

ITEM	QTY.	DESCRIPTION	P/N
A	1	Air Box	AL1167-00
B	6	Washer, Flat, 6mm	AI1535-00
C	2	Screw, Hex Head, M6-1.0x30mm	AI1257-00
D	1	S&B Air Filter	KF-1055
E	1	Hose Clamp, #80	AG1010-00
F	3	Hose Clamp, #64	AG1018-00
G	1	Hose Clamp, #72	AG1009-00
H	1	Clear Lid	AI1528-00
J	2	Washer, Rubber, 5/16"	AI1435-00
K	2	Screw, Truss Head, 5/16-18x1"	AI1297-00
L	2	Washer, Sealing, #10	AI1272-00
M	2	Screw, Phillips Pan, #10-24x1/2"	AI1287-00
N	1	Screw, Socket Cap, 1/4-20x7/8"	AI1570-00
P	2	Screw, Phillips Pan, #8-32x1/2"	AI1479-00

ITEM	QTY.	DESCRIPTION	P/N
S	4	Nut, Speed Tapped Hole, 1/4-20	AI1059-00
T	1	Box Plug	AL1176-00
U	4	Screw, Hex Head Cap, 1/4-20x1"	AI1131-00
V	1	Hose Barb, 90deg. 3/8x1/4NPT	AI1307-00
W	1	Silicone Breather Hose, 18"	AI1572-00
Y	1	Adapter Tube	AL1186-00
AA	1	Intake Tube	AL1187-00
AB	1	Hump Coupler, 3.875"IDx3.0" Long	AI1551-00
AC	1	Silicone Step Coupler	AI1542-00

AM0198-00 RevA 08/15/13

**Warranty**

Visit [www.sbfilters.com/Support/Why-S-B/Million-Mile-Limited-Warranty](http://www.sbfilters.com/Support/Why-S-B/Million-Mile-Limited-Warranty) for S&B Filter's complete warranty.