



**WARNING!**

**(MUST READ PRIOR TO INSTALLATION)**

**I. Water Ingestion Disclaimer:**

This product is intended for general highway use only! Under normal driving conditions water ingestion is usually not an issue; however, if the product becomes submerged from rain splashes or mud puddles due to harsh rains or flooding the engine may ingest water which could cause severe engine damage. Do NOT use this product when crossing any body of water including but not limited to large puddles, streams, rivers or lakes. **S&B has conducted extensive water testing with Southwest Laboratories to design a product, which was engineered to protect your vehicle. The testing was done at 612 CFM and according to the SAE J2554, Engine intake Air Water Separation Test Procedure that has been attached and can also be found on our website.**

If your engine ingests water, this could cause severe engine damage by hydro-lock or other conditions. Care should be taken to avoid these driving conditions. **ENGINE DAMAGE CAUSED BY THE INGESTION OF WATER INTO THE ENGINE IS THE DRIVER'S RESPONSIBILITY AND IS NOT COVERED BY S&B FILTERS!**

The table below demonstrates what percentage of the water bypassed the filter during the SAE J2554 Test Procedure.

<b>Standard Scoop Configuration With:</b>	<b>Water Bypassing the Filter, %</b>
Cotton Filter (KF-1052)	0.00

Visit [www.sbfilters.com](http://www.sbfilters.com) to see the entire Test Report and learn more about this product.

**II. Scoop Obstruction:**

Regularly inspect the entire Scoop Inlet for any obstruction or debris that may impede the flow of air.

**III. Decreased Ride Height**

Once the Scoop has been installed, please be aware that the Scoop sits lower than the bumper and drive accordingly to avoid damage to the scoop or vehicle. Make sure there is plenty space between your tire and the scoop before driving. The scoop system may not work with aftermarket wheels and tires.

**IV. Do NOT Seal Off Stock Inlet Location:**

In addition to pulling air from the base of the air box, the S&B Cold Air Intake Kit pulls air from the same location as the stock induction system. **UNDER NO CIRCUMSTANCE SHOULD YOU SEAL OFF THIS AIR INLET.** Doing so could result in severe injury or death or damage to the vehicle or property. Sealing off the stock air inlet could cause a significant vacuum should the Scoop become partially or completely obstructed which among other things could pull oil into intake tube leading to an explosion and/or a run-away truck condition as the oil would serve as fuel to the engine.

**V. Warranty for Scoop & Filter Wrap**

S&B provides a limited warranty to guarantee the product is free of material and workmanship defects. Any product will be replaced upon identification of such defect. Normal wear and tear is not covered under this warranty. Final authorization is at the sole discretion of S&B Filters, Inc.

**VI. How long will the Scoop & Filter Wraps Repel Water?**

The Scoop & Filter Wraps are specially treated to repel water. The water repellency longevity is dependent upon driving conditions and the number of times the filter is cleaned. Generally speaking, we recommend changing the Filter Wrap every 6-12 months. However, a quick test can determine if it is time to change your Filter Wrap. Simply take an ordinary clean spray bottle filled with water and gently spray the Filter Wrap. If the water beads off the Filter Wrap, your water repellency is still working. If you see water enter through the Filter Wrap, it is time to purchase a new Filter Wrap.



## INSTALLATION INSTRUCTIONS

Important: Read warning page prior to proceeding.

### VEHICLE APPLICATION

Year: 2011-13  
 Make: GMC (Only)  
 Model: 2500/ 3500HD  
 Engine: 6.6L LML Diesel

### OE GMC BUMPERS ONLY



### TOOLS REQUIRED

- 5/16", 1/2", 8mm, 10mm Sockets
- 5/16", 1/2", 8mm, 10mm Wrenches
- 5/16" Nut Driver
- Phillips and Flat Blade Screwdriver
- Pliers

### NOTES

Kit may NOT fit with the following:

- Chevy trucks
- Aftermarket Bumper
- Body Lift or Lowering Kit
- Front Hitch
- Oversized Wheels and Tires



### Thread Locker Use

We have provided a small tube of thread locker in your kit. Whenever you see the symbol above on a step of the instructions apply 1 small drop of the thread locker to the threads of the screws or bolts. This will keep your hardware from vibrating loose during rough driving. If the hardware ever needs to be removed, do so slowly to avoid having the inserts strip out from the plastic. DO NOT USE ON LID HARDWARE, MAY CAUSE CRACKS.

### BEFORE YOU START

- Please read the entire product guide before proceeding.
- Ensure all components listed on page 5 are present.
- If you are missing any of the components, call our customer support at (909) 947-0015.
- Do not work on your vehicle while engine is hot.
- Make sure the engine is turned off and the vehicle is in Park or the Parking Brake is set.

1. With the ignition switched off and the parking brake set, disconnect the negative battery cables on both batteries.



2. Remove the 4 screws attaching the clear lid to the air box.

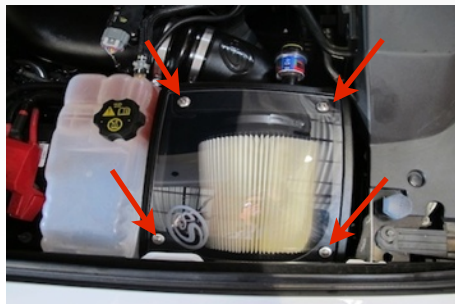

3. Loosen both hose clamps on the hump adapter and slide the hump adapter over the adapter tube. Loosen clamp and slide intake tube out of the turbo adapter. Then remove the Adapter tube and Air Filter from the air box.



4. If installed, remove the air box plug from the air box. If not, install the three clip nuts that were supplied with the intake kit onto the bottom opening lip of the air box.



5. Loosen the four bolts mounting the air box to the truck.

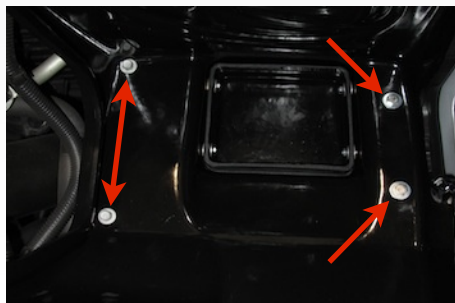

6. From under the truck; remove the two screws mounting the plastic shield. Save this piece so it can be reinstalled during heavy rain and snow.

See Note on page 3.

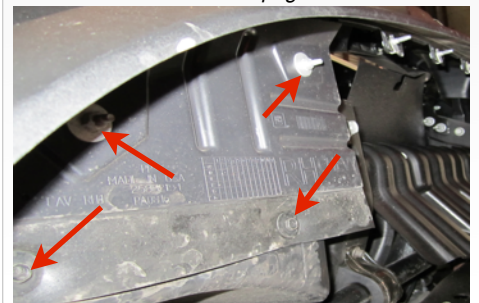

7. Remove the two clip nuts from the wheel liner and the two bolts and clip nuts from the bumper trim.



8. Slide the Scoop Assembly up into the bottom of the air box from under the vehicle. Then position the base of the scoop on top of the bumper trim tabs and wheel liner lip.



9. From inside the air box grab the top of the Scoop assembly and align with the four holes in the air box. **Note:** It may be necessary to move some wiring harnesses out of the way to gain clearance for the scoop assembly.



SEE EXPLODED VIEW ON PAGE 4



**INSTALLATION INSTRUCTIONS (continued)**

10. Attach the Scoop assembly to the Air box using the hardware removed in step #4 (four #10-32 Screws and Sealing washer supplied with the intake system). Secure all four screws.



11. Using the supplied 5/16-18 Hex Bolts (C) and Flat Washers (B), attach the scoop to the wheel liner and bumper trim. Tighten all four bolts.

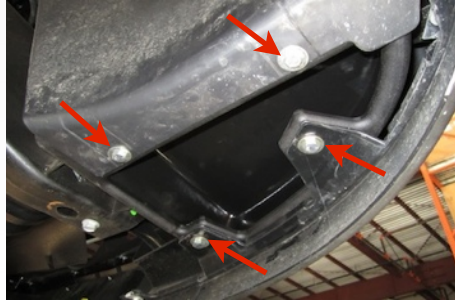

12. Tighten down the four screws in the bottom of the air box.

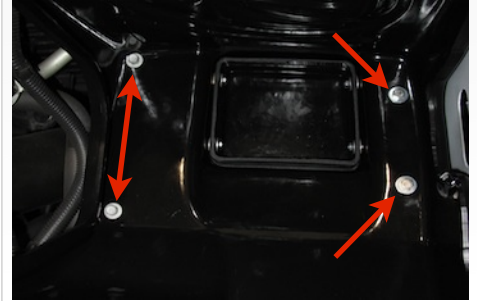

13. Reinstall the adapter tube and Air Filter into the air box. Reinstall the intake tube into the turbo adapter. Slide the hump adapter back over the intake tube connection and tighten all hose clamps.



14. Reinstall the clear lid and tighten all four screws.

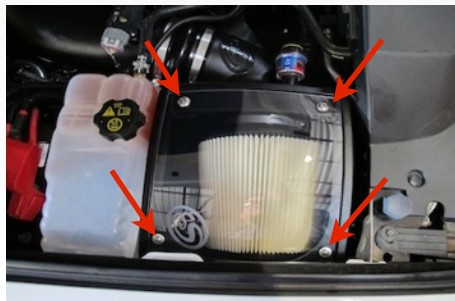

15. Reconnect the negative battery terminal. Inspect the installation, be sure the kit is properly positioned and all fasteners are secure.



16. Check to make sure the Scoop assembly does not interfere with the wheel or wheel well liner. Turn the wheel in both directions while trying to simulate full suspension travel.



**Scoop Block-off Plate**

The plastic shield that was removed in Step #6 can be re-used as a block-off plate during heavy rain or snow. Simply remove the four screws and washers from the bottom of the scoop; then place the plastic plate over the base of the scoop and re-install the four screws and washers. Never submerge the base of the scoop in water, snow or sand (with or without the block-off plate).



**SEE EXPLODED VIEW ON PAGE 4**



## INSTALLATION INSTRUCTIONS (continued)

### REMINDER!

#### Water Ingestion Disclaimer:

This product is intended for general highway use only! Under normal driving conditions water ingestion is usually not an issue; however, if the product becomes submerged from rain splashes or mud puddles due to harsh rains or flooding the engine may ingest water which could cause severe engine damage. Do NOT use this product when crossing any body of water including but not limited to large puddles, streams, rivers or lakes.

If your engine ingests water, this could cause severe engine damage by hydro-lock or other conditions. Care should be taken to avoid these driving conditions. **ENGINE DAMAGE CAUSED BY THE INGESTION OF WATER INTO THE ENGINE IS THE DRIVER'S RESPONSIBILITY AND IS NOT COVERED BY S&B FILTERS!**

#### Scoop Obstruction:

Regularly inspect the entire Scoop Inlet for any obstruction or debris that may impede the flow of air.

#### Decreased Ride Height

Once the Scoop has been installed, please be aware that the Scoop sits lower than the bumper and drive accordingly to avoid damage to the scoop or vehicle. Make sure there is plenty space between your tire and the scoop before driving. The scoop system may not work with aftermarket wheels and tires.

#### PERFORMANCE TESTING

- Engage parking brake and start your engine. Listen for abnormal noises. If an air leak is detected, re-inspect hoses and connections as they may need to be repositioned and tightened.
- S&B FILTERS recommends that you keep your OE intake system in the event it is required in the future.
- In order to maintain your warranty, all connections and components must be checked periodically for alignment and for proper tension on all connections. Failure to do so may void your warranty.
- Use only S&B FILTERS cleaning and oil products to service your filter. Using any other brand oil and or cleaners on your S&B air filter may void your warranty.

#### RELATED ITEMS FOR YOUR PURCHASE

- Air Filter Wrap (S&B P/N: WF-1033)

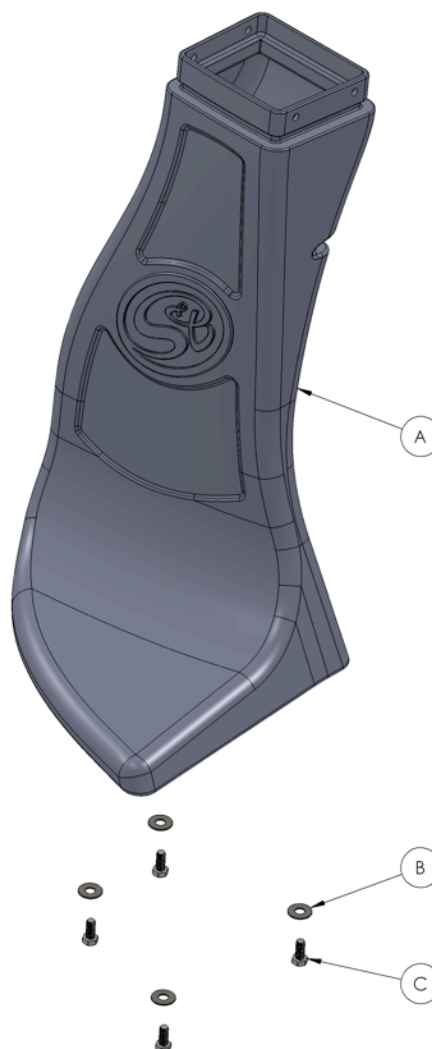

ITEM	QTY.	DESCRIPTION	P/N
A	1	Cold Air Scoop	AL1177-00
B	4	Washer, Flat	AI1093-00
C	4	Cap Screw, Hex, 5/16-18x3/4"	AI1467-00